



KIGAN
- MASTER HAND -



Kigan Guides | About

Founded in 1978, Kigan has grown into a leading fishing rod components manufacturer specializing in fishing rod guides. In 2010, Kigan began a new era with 3D guides. Kigan's unique 3D press construction maximizes durability against ring separation by establishing perfect contact between the ceramic ring and metal frame.

Rather than follow others, Kigan has developed new guide technology that moves past decade old design. This innovation sets a new standard with modern manufacturing methods and forward thinking designs that produce lasting products which increase the performance of any equipped rod. Kigan has also answered the micro guide market by offering more micro guide options than any other manufacturer. In addition to outstanding selection, Kigan's micro guides and tip tops are easily best in class in several areas including design and durability.

Kigan is an ISO 9001:2000 accredited manufacturing entity.

Z Guides (Pat. P) - "Z"

KIGAN

- MASTER HAND -

Kigan Z Guides answer the need.

Braided line has the unique characteristics of being highly pliable and having little to no stretch. As a result, this increases the chances for line fouling and increases the amount of pressure transferred to rod guides. Kigan Z Guides are designed to specifically address these issues in both standard and micro guide sizes.

Kigan Z Guides improve on existing zero tangle theory by removing the potential for line interference. Kigan's 3D press method allows Z Guide legs and ring frames to be designed separately. They are then pressed from one piece of metal to produce a guide

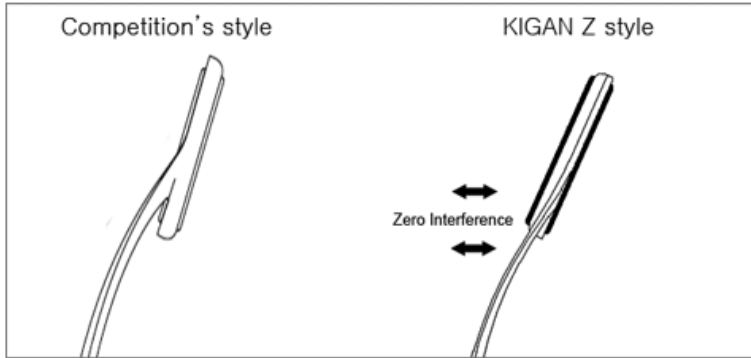

where line is not able to wedge between the ring frame and guide leg. Another benefit is the entire guide and ring frame has a more aggressive forward tilt to shed line easier. These are significant improvements in guide design.

The Z guide incorporates a two step projection on running sizes for increased wrapping strength without increasing guide weight. This helps address the energy transfer demands from fouled braided line.



Ring Material	Frame Color	Part ID
Coalite	Black	ZCGBC
	White Chrome	ZCGWC
	CC (Saltwater)	ZCGCC
Zirconia (available in four ring colors)	Black	ZZSGBC
	White Chrome	ZZSGWC
	CC (Saltwater)	ZZSGCC
	Gunmetal	ZZSGGU
	Grey	ZZSGIC
	Ion Gold	ZZSGIG
	Aurora	ZZSGIA



RING	H	L	L1
	(mm)	(mm)	(mm)
3	4.7	8.3	4.6
4	5.9	8.3	5.2
5	6.3	9.4	6.2
5.5	7.4	9.7	6.3
6	8.7	10.6	6.5
7	9.1	11.2	6.8
8	11	14.9	8.7
10	14.7	16.5	9.5
12	18.8	22.5	12
16	25.7	26.4	14.2
20	33.8	29.8	14.5
25	43	43	18.6
30	59	52	19



Top Guides - “MZ” & “Z”



Kigan Micro Zero Tangle “MZ” Top Guides

Kigan MZ Top Guides are ideally designed to provide strong, braced tip tops compatible with all of today’s micro guide systems. The MZ top is quickly proving to be the gold standard in micro tip top design.

Kigan Z Top Guides have become a favorite on casting and spinning rods due to their outstanding performance and sleek design.

Design is mindful of both strength and aesthetics. It incorporates Kigan’s 3D design providing incredibly strong ring/frame bonds. Braces are short for increased strength and reduced side impact damage. The brazing of the braces into the side of the tube eliminates the hang points found on other tops. This innovative design offers a zero tangle tip top design.

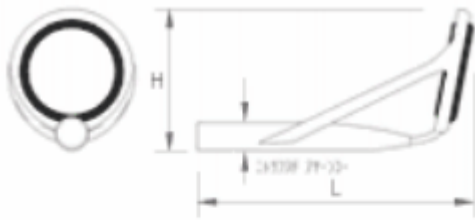

RING	PIPE I/D (mm)	L (mm)	H (mm)	O/D (mm)
4	1.6	13.5	6.3	1.8
	1.8	13.5	6.3	2.1
	2	14	6.3	2.3
	2.2	14	6.3	2.5
	2.4	14.5	6.5	2.7
	2.6	14.5	6.5	2.9
	2.8	16	6.5	3.2

Ring Material	Frame Color	Part ID
Coalite	Black	ZCTBC
	White Chrome	ZCTWC
	CC (Saltwater)	ZCTCC
SiC	Black	ZSTBC
	White Chrome	ZSTWC
	CC (Saltwater)	ZSTCC
	Gunmetal	ZSTGU
	Grey	ZSTIC
Zirconia (available in four ring colors)	Black	ZZSTBC
	White Chrome	ZZSTWC
	CC (Saltwater)	ZZSTCC
	Gunmetal	ZZSTGU
	Grey	ZZSTIC
	Ion Gold	ZZSTIG
	Aurora	ZZSTIA

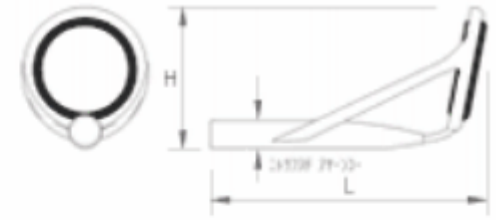

RING	PIPE I/D (mm)	L (mm)	H (mm)	O/D (mm)
6	1.6	15.5	7.3	1.8
	1.8	15.5	7.3	2.1
	2	15.5	7.3	2.3
	2.2	15.5	7.3	2.5
	2.4	16	7.5	2.7
	2.6	16	7.5	2.9
	2.8	17	17	3.2

SF Casting Guides - "C"

KIGAN

- MASTER HAND -

Kigan Single Foot Casting "C" Guides

Kigan C Guides were developed to answer the needs of rodbuilders worldwide. These guides boast features such as the exclusive 3D design, correct calculation of the bend radius from foot to guide ring eliminating guide shearing, easy to wrap, room for locking wraps, and astoundingly low failure rates.

In smaller sizes, C Guides excel in micro guide applications and in other sizes are easily top performers on any spin, cast or fly rod built for freshwater and light saltwater applications.



Ring Material	Frame Color	Part ID
Coalite	Black	CCGBC
	White Chrome	CCGWC
	CC (Saltwater)	CCGCC
SiC	Black	CSGBC
	White Chrome	CSGWC
	CC (Saltwater)	CSGCC
	Gunmetal	CSGGU
	Grey	CSGIC
Zirconia (available in four ring colors)	Black	CZSGBC
	White Chrome	CZSGWC
	CC (Saltwater)	CZSGCC
	Gunmetal	CZSGGU
	Grey	CZSGIC
	Ion Gold	CZSGIG
	Aurora	CZSGIA

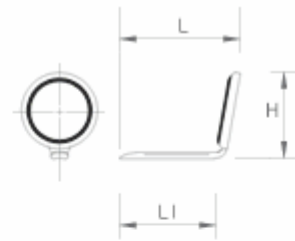

RING	H	L	L1
	(mm)	(mm)	(mm)
3	5.2	7	5.6
4	6.1	7.5	7.2
5	6.6	7.6	6.8
5.5	7.7	8.2	7.3
6	8.6	8.8	8.2
7	9.6	9.1	8.5
8	11.9	9.1	8.1

DF Casting Guides - "CD"



Kigan Double Foot Casting "CD" Guides

Kigan CD Guides are the perfect choice for heavy casting rod running guides and fly rod stripper guides. CD Guides are often used on light casting rods as stripper guides, giving perfect complement when using C Guides as running guides.

As with all Kigan offerings, CD Guides utilize Kigan's 3D press method of construction which allows significant advantages in ring/frame bond longevity while remaining light in overall weight. These guides easily shed line, endure demanding use, are easy to wrap, and are highly functional while remaining pleasing to the eye.



Ring Material	Frame Color	Part ID
Coalite	Black	CDCGBC
	White Chrome	CDCGWC
	CC (Saltwater)	CDCGCC
SiC	Black	CDSGBC
	White Chrome	CDSGWC
	CC (Saltwater)	CDSGCC
	Gunmetal	CDSGGU
	Grey	CDSGIC
Zirconia (available in four ring colors)	Black	CDZSGBC
	White Chrome	CDZSGWC
	CC (Saltwater)	CDZSGCC
	Gunmetal	CDZSGGU
	Grey	CDZSGIC
	Ion Gold	CDZSGIG
	Aurora	CDZSGIA



RING	H	L	L1	L2
	(mm)	(mm)	(mm)	(mm)
6	9.1	17	5	5.5
7	10.9	18.4	4.8	6.1
8	12.4	18.6	6.3	6.6
10	16.1	20.9	7.3	7.5
12	19	23.1	7.7	7.6

Spin Guides - "S"

K I G A N

- MASTER HAND -

Kigan Single Foot Spinning "S" Guides

Kigan S Guides are designed for use on light and medium spinning rods and are perfectly matched with C Guides as runners. The split leg frame design takes advantage of Kigan's 3D press method to produce a lighter weight than comparative guides.

Guide train set up is easy as S Guides have been designed to reduce in size and height appropriately, eliminating the need for both high and low framed guide series.



Ring Material	Frame Color	Part ID
Coalite	Black	SCGBC
	White Chrome	SCGWC
	CC (Saltwater)	SCGCC
SiC	Black	SSGBC
	White Chrome	SSGWC
	CC (Saltwater)	SSGCC
	Gunmetal	SSGGU
	Grey	SSGIC
Zirconia (available in four ring colors)	Black	SZSGBC
	White Chrome	SZSGWC
	CC (Saltwater)	SZSGCC
	Gunmetal	SZSGGU
	Grey	SZSGIC
	Ion Gold	SZSGIG
	Aurora	SZSGIA

RING	H	L	L1
	(mm)	(mm)	(mm)
7	15.1	10.2	7.3
8	17.3	12.5	8.8
8L	14.1	10.8	8.5
10	21	13.7	10.6
12	26.2	19.3	12.3
16	33.9	20.7	13.1
20	41.9	25.9	16.7
25	50.5	27.5	19.5
30	60.5	31.3	20.6